

OSMO

Extension Rod

Quick Start Guide V1.0

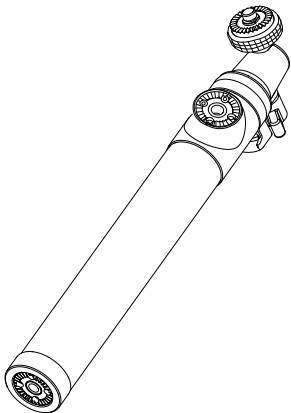

Disclaimer and Warning

Congratulations on purchasing your new DJI product. The information in this document affects your safety and your legal rights and responsibilities. Read this entire document carefully to ensure proper configuration before use. Failure to read and follow instructions and warnings in this document may result in serious injury to yourself or others, damage to your DJI product, or damage to other objects in the vicinity. This document and all other collateral documents are subject to change at the sole discretion of DJI. For up-to-date product information, visit <http://www.dji.com> and click on the product page for this product.

By using this product, you hereby signify that you have read this disclaimer and warning carefully and that you understand and agree to abide by the terms and conditions herein. You agree that you are solely responsible for your own conduct while using this product, and for any consequences thereof. You agree to use this product only for purposes that are proper and in accordance with all applicable laws, rules, and regulations, and all terms, precautions, practices, policies and guidelines DJI has made and may make available.

DJI accepts no liability for damage, injury or any legal responsibility incurred directly or indirectly from the use of this product. The user shall observe safe and lawful practices including, but not limited to, those set forth in this document.

Introduction

The Extension Rod for the Osmo extends up to 980 mm in length and is great for taking group selfies, overhead shots or reaching into small spaces. A lockable 360° swivel allows the Osmo to be positioned at virtually any angle. The rod comes with two extra rosette mounts on its handle.

Specifications

Diameter: 29 mm

Collapsed Length: 235 mm

Max Length: 980 mm

Rod Sections: 155 mm

Weight: 258 g

Collapsed

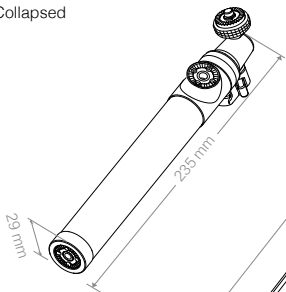

Extended

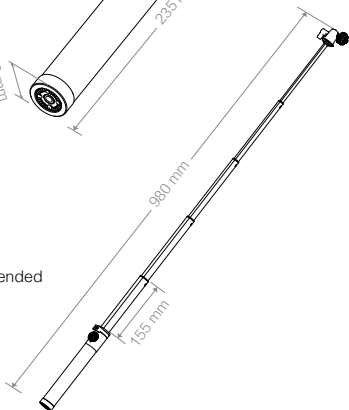

Installation

1. Ensure the inner knob is screwed in and touches the outer knob.
2. Release the swivel lock so that both knobs can rotate freely.

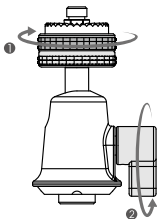

3. Attach the Extension Rod to the rosette mount on the Osmo handle and tighten the knob to secure.
4. You may notice a small gap between the teeth of the two rosette mounts. Now, turn the inner knob to close this gap.
5. Move the Osmo as desired and then tighten the swivel lock to lock its position.

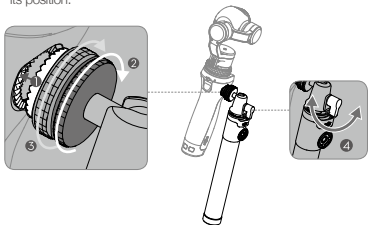

6. To adjust the length of the Extension Rod, turn the handle counter-clockwise to unlock the rod. Be sure to re-lock the rod after the adjustment has been made.



WARNING

Ensure the Osmo is mounted securely and will not fall off.

This content is subject to change.

Download the latest version from
www.dji.com/product/osmo

If you have any questions about this document, please contact DJI by sending a message to DocSupport@dji.com.